

# North American Refugee Health Conference

Health means the world to us

[northamericanrefugeehealth.com](http://northamericanrefugeehealth.com) | #NARHCTO



Program

# Welcome Letter



## North American Refugee Health Conference 2019: Celebrating Ten Years of Refugee Health

The North American Refugee Health Conference (NARHC) grew out of a shared vision of improving health outcomes for refugees. From its humble beginnings, NARHC has grown to be recognized as the premier refugee health conference globally.

Over the past ten years, NARHC has:

- Transcended refugee healthcare from an interest group to an evolving specialty
- Acted as the catalyst in the creation of the North American Society of Refugee Healthcare providers
- Demonstrated leadership in advocacy for contemporary and urgent refugee issues
- Developed research networks
- Led to the development of refugee health best practices and policy
- Helped to develop dialogue and collaboration between policymakers overseas such as UNHCR, IOM and domestic frontline refugee workers, policy makers and researchers

These accomplishments and the continued success of the conference can be attributed to the passionate and committed participants, committee members and professionals engaged in improving refugee health outcomes through education, research and advocacy

This year's conference is being held at a time when the world is witnessing the unprecedented migration of populations. The destruction in Syria continues and the horrors experienced by the Rohingya as villages are burned to the ground in Burma are coming to light. Sessions will explore these issues and others. Speakers will include the Honourable Bob Rae who will discuss the atrocities he witnessed as Special Envoy for Myanmar on the Rohingya crisis; Dr. Maya Prabhu, psychiatrist and lawyer, from Yale University who will discuss trauma, resiliency and supporting health care providers working with traumatized refugee populations; and Zozeya Hassan who will describe her horrific time being held captive by ISIS. Migrations stories will also be shared through the music of A2VT who journeyed from Africa to Vermont.

In addition, two pre-courses: Nutrition and Health Status of New Canadians: Readiness for Culturally appropriate Care with the Canadian Nutrition Society and the Clinical Tropical Medicine and Traveler's Health Update Course with the American Society of Tropical Medicine and Hygiene will be offered as a lead-in to the conference.

On behalf of the entire conference committee, I welcome you to the 2019 North American Refugee Health Conference. We look forward to the discussions on best health practices, how to address challenges for optimal care and self-care for the healers.

**Anna Banerji** O.Ont, MPH, MD, FRCPC, DTM&H  
Chair & Conference Director, North American Refugee Health Conference 2019

# Table of Contents

Welcome Letter from Conference Chair . . . . .	2
Floor Map . . . . .	4
Planning Committee . . . . .	5
Speaker Bios . . . . .	6
Invited Speakers, Special Refugee Invitees, Concurrent Plenary Speakers . . . . .	11
Accreditation, Interactive Learning, Disclosure Statement. . . . .	12
Program Friday, June 14, 2019 . . . . .	13
Program Saturday, June 15, 2019 . . . . .	16
Program Sunday, June 16, 2019 . . . . .	20
Posters Friday, June 14, 2019 . . . . .	23
Posters Sunday, June 16, 2019 . . . . .	25
Sponsors. . . . .	28

## Wi-Fi Internet Access

1. Connect to the Wi-Fi network called: **Sheraton\_Conference**
2. Once connected, open your internet browser where you will be automatically redirected to the Sheraton’s web page.
3. Enter the access code: **NARHC2019**

## Submitting Keynote & Plenary Questions

1. Connect to the Internet on your laptop or mobile device and open your internet browser.
2. Go to **Slido.com** and enter the name of your room in the code area (Osgoode, Sheraton, Willow, or Chestnut).
3. Type in your question or “Like” a question someone else has asked.
4. The moderator will review the questions and ask the speaker during Q & A.

Workshop, Oral, and Poster Session Abstracts are available for download at:

**[northamericanrefugeehealth.com/abstracts](http://northamericanrefugeehealth.com/abstracts)**

Share your experience on social media with the hashtag **#NARHCTO**

## Lower Concourse

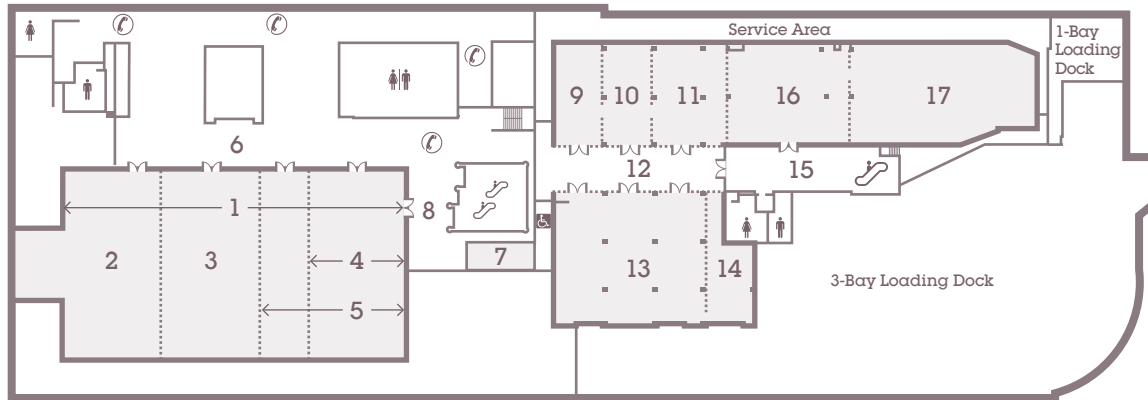

## Mezzanine

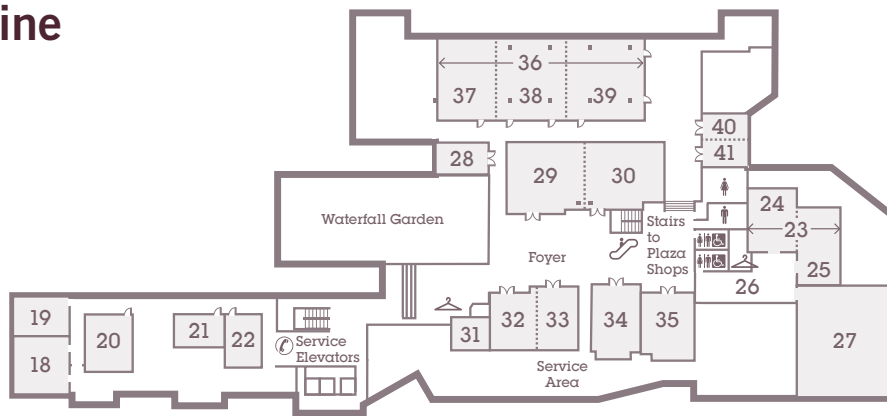

- |                        |                          |                            |
|------------------------|--------------------------|----------------------------|
| 1 Grand Ballroom       | 16 Osgoode Ballroom West | 29-30 Chestnut West & East |
| 2 Grand West           | 17 Osgoode Ballroom East | 31 Mezzanine Office        |
| 3 Grand Centre         | 16-17 Osgoode Ballroom   | 32 Maple West              |
| 4 Grand East           | 18 York                  | 33 Maple East              |
| 5 Grand East (Large)   | 19 Peel                  | 32-33 Maple West & East    |
| 6 Grand Ballroom Foyer | 20 Norfolk               | 34 Linden                  |
| 7 Vide Office          | 21 Oxford                | 35 Cedar                   |
| 8 Vide                 | 22 Carleton              | Mezzanine Foyer            |
| 9 Sheraton Hall A      | 23 Pine                  | 36 Willow                  |
| 10 Sheraton Hall B     | 24 Pine West             | 37 Willow West             |
| 11 Sheraton Hall C     | 25 Pine East             | 38 Willow Centre           |
| 12 Sheraton Hall D     | 26 Birchwood Foyer       | 39 Willow East             |
| 13 Sheraton Hall E     | 27 Birchwood Ballroom    | 40 Spruce North            |
| 14 Sheraton Hall F     | 28 Oak                   | 41 Spruce South            |
| 9-14 Sheraton Hall     | 29 Chestnut West         | 40-41 Spruce               |
| 15 Osgoode Foyer       | 30 Chestnut East         |                            |

# Planning Committee

**Anna Banerji** O.Ont, MD, MPH,  
FRCPC, DTM&H  
Conference Director & Chair  
Faculty Lead, Indigenous and Refugee  
Health, Post MD Education  
Faculty of Medicine, University of Toronto  
Associate Professor Pediatrics and Dalla Lana  
School of Public Health

---

**Hind Adam** MBBS  
Ahfad University for Women  
Former refugee

**Aniyizhai Annamalai** MD  
Associate Professor, Yale School of Medicine  
Medical Director, Yale Adult Refugee Clinic

**Marc Altshuler** MD  
Associate Professor, Family and  
Community Medicine  
Associate Program Director,  
Family Medicine Residency Program  
Director, Jefferson Center for  
Refugee Health  
Thomas Jefferson University

**Neil Arya** MD, CCFP, FCFP, DLitt  
Assistant Clinical Professor, Family Medicine  
McMaster University  
Adjunct Professor, Family Medicine  
Western University  
Adjunct Professor, Environment and  
Resource Studies  
University of Waterloo

**Carolyn Beukeboom** PHC-NP, MSc  
Adjunct Assistant Professor, Arthur Labatt  
Family School of Nursing  
Western University  
Assistant Clinical Professor, School of  
Nursing, McMaster University

**Mahli Brindamour** MD, FRCPC  
General Pediatrician  
Assistant Clinical Professor  
University of Saskatchewan

**Jennifer Cochran** MPH  
Director, Division of Global Populations  
and Infectious Disease Prevention  
Bureau of Infectious Disease  
Massachusetts Department of Public Health

**Peter Cronkright** MD FACP  
Associate Professor of Medicine  
SUNY-Upstate Medical University  
Primary Care Internist  
Syracuse, New York

**Paul L. Geltman** MD, MPH  
Medical Director, Refugee and  
Immigrant Health  
Division of Global Populations and  
Infectious Disease Prevention  
Massachusetts Department of Public Health  
Assistant Professor, Pediatrics  
Harvard Medical School  
Associate Professor, Health Policy and  
Health Services Research  
Boston University Goldman School of  
Dental Medicine

**Andrea Green** MDCM, FAAP  
Associate Professor Pediatrics  
University of Vermont  
Director, Pediatric  
New American Clinic

**Brian D. Gushulak** MD  
Migration Health Consultants, Inc.

**Manisha Hladio** MSc, MD, CCFP  
Sanctuary Refugee Health Centre, Kitchener  
Assistant Clinical Professor, Family Medicine  
McMaster University

**Patricia Li** MD, MSc, FRCPC  
Assistant Professor, Paediatrics  
Division of General Paediatrics  
Montreal Children's Hospital  
McGill University Health Centre

**Rachel F. Spitzer** MD, MPH, FRCS(C)  
Associate Professor and Vice Chair,  
Global Health  
Department of Obstetrics and Gynecology,  
University of Toronto

**William Stauffer** MD, MSPH, DTM&H  
Associate Professor  
Division of Infectious Diseases &  
International Medicine  
University of Minnesota, School of Medicine

**James B. Sutton** RPA-C  
Director, Office of Community Medicine  
Director, Refugee Healthcare Program  
Rochester General Health System

**Hassan Vatanparast** MD, PhD  
Professor, College of Pharmacy and  
Nutrition  
School of Public Health  
University of Saskatchewan

**Patricia Walker** MD, DTM&H  
HealthPartners Center for International  
Health and Travel Medicine Clinics  
Associate Program Director,  
Global Health Pathway  
Associate Professor, Division of  
Infectious Disease  
and International Medicine  
Department of Medicine  
University of Minnesota

**Mei-ling Wiedmeyer** MD, CCFP  
Clinical Instructor, Family Practice  
University of British Columbia  
Family Physician  
Umbrella Multicultural Health Co-op

**Vanessa Wright** NP-PHC, MScN  
Nurse Practitioner  
The Crossroads Clinic  
Women's College Hospital

**Janine Young** MD, FAAP  
Medical Director, Denver Health  
Refugee Clinic  
Medical Advisor, Colorado Refugee  
Services Program  
Associate Professor, General Pediatrics  
University of Colorado School of Medicine  
Denver Health and Hospitals



## Conference Chair Bio



### Anna Banerji

Dr. Anna Banerji is a pediatric infectious and tropical disease specialist. She has trained in Toronto, Ottawa, Montreal, and Harvard University, where she completed her MPH in International Health. Currently Dr. Banerji is the Post MD Education lead for Indigenous and Refugee Health, where she co-founded the North American Refugee Health Conference, and founded and chairs the Indigenous Health Conference.

Dr. Banerji has travelled extensively around the world, including work in Haiti after the earthquake, which has given her considerable exposure to tropical medicine in poor resource settings. Most of Dr. Banerji's clinical work for the past 20 years has focused on: immigrant, refugee and internationally adopted children. In 2014, she created the COSTI Pediatric Clinic, where she screens all the newly arrived Government Assisted Refugee Children coming to Toronto. In 2016 she set up a clinic at a hotel to assess the newly arrived Syrian refugee and screened over 700 Syrian children over the year.

She has been studying lower respiratory infections in Inuit children for almost 25 years, where her research has led to changes to the national guidelines for the prevention of RSV. She uses a human rights framework for her work, research and education and is an advocate for vulnerable populations. In January 2012, she was inducted into the Order of Ontario.

## Keynote Speaker Bios



### The Honourable Bob Rae

Born in Ottawa and a graduate of both the University of Toronto and Oxford, Bob Rae was first elected to the Parliament of Canada as the Member of Parliament for Broadview in a by-election in October, 1978. He was re-elected in 1979 and 1980, and resigned his seat in 1982 when elected Leader of the Ontario New Democratic Party. He was elected to the Legislative Assembly for the riding of York South in 1982, and re-elected in 1985, 1987, 1990, and 1995. After more than a decade as a partner at Goodmans LLP Bob returned to federal politics as the MP for Toronto Centre in 2008, first in a by-election and then in general elections in that year and 2011. Bob resigned his seat in 2013 to become senior partner at Olthuis Kleer Townshend LLP, where he works with First Nations as legal counsel, advisor, and negotiator.

Bob served as Ontario's 21st Premier from 1990 to 1995 and Interim Federal Leader of the Liberal Party in 2011- 2013. He was named Queen's Counsel in 1984, appointed to the Privy Council of Canada in 1998, named an Officer of the Order of Canada in 2000, received the Order of Ontario in 2004 and Companion of the Order of Canada in 2015. In October, 2017 Bob was appointed as Special Envoy to Myanmar by Prime Minister Justin Trudeau.

In addition to his legal practice, Bob teaches at the University of Toronto as a Distinguished Senior Fellow at the School of Public Policy and Governance (SPPG), and as Distinguished Professor at Victoria College. He is a Fellow at the Forum of Federations, and consults internationally on governance issues. He has also written five books and two major reports, on the Air India bombing and higher education in Ontario. He writes and speaks regularly on public issues and also does ADR work with ADR Chambers.

## Keynote Speaker Bios



### Paul Caulford

Doctor Caulford has practiced Family Medicine in Scarborough for 40 years. He is the Past Chief of Family and Community Medicine at The Scarborough Hospital and past Program Director for Family Medicine Residency training at the University of Toronto, Scarborough Program. He is the past Ontario Provincial Primary Care Lead Physician in the Central East Local Health Integrated Network. Dr. Caulford graduated from the University of Toronto School of Medicine in 1978. Prior to that he graduated from the same University with an Honours Bachelor of Science and a Master of Science at Toronto's Hospital for Sick Children.

In 1999, during his first week as Chief of Family Medicine a young refugee teenager almost died when she was turned away for care from the emergency department for lack of a health card. That event prompted Dr. Caulford, with Ms. Jennifer D'Andrade and another colleagues to found the Community Volunteer Clinic for medically uninsured immigrants and refugees residing in Canada. They operated the first free clinics from a donated church basement on Kennedy Road. As world refugee numbers grew so did the abundance of volunteer doctors, dentists, nurses, nurse practitioners, social workers and community members who stepped forward to help. Donating their medical skills, time and money and with strong support from the Rotary Club of Scarborough in 2015 The Canadian Centre for Refuge and Immigrant Health Care was established – a permanent home for the free refugee clinics, and a centre of knowledge and academics in global health. In 2018 the Ontario Ministry of Health and Long-Term care recognized the CCRIHC's contributions in the form of base funding support, as a Centre for health access equity for newcomers in the GTA. The CCRIHC and its team has become locally, nationally and internationally recognized and awarded as a Centre of excellence and an advocacy voice in refugee and immigrant medical and dental care.

Dr. Caulford is married to his wife Marta for 48 years. They enjoy time with their 5 children and grandchildren.



### Martin Cetron

CDC's Division of Global Migration and Quarantine (DGMQ) helps protect the health of our communities in a globally mobile world. As director of DGMQ, Martin (Marty) Cetron, MD is a leader in global health and migration with a focus on emerging infections, tropical diseases, and vaccine-preventable diseases in mobile populations. Dr. Cetron received his B.A. from Dartmouth College in 1981 and his

M.D. from Tufts University in 1985. He trained in Internal Medicine at the University of Virginia and Infectious Diseases at the University of Washington before joining the CDC's Epidemic Intelligence Service and becoming a Commissioned Officer in the US Public Health Service (PHS) in 1992.

Dr. Cetron is a graduate of the Harvard School of Public Health & Kennedy School of Government's National Preparedness Leadership Institute. For over 20 years, he has been a leader in public health emergency preparedness and response activities at CDC, including high profile international emergency responses to emerging infectious disease outbreaks. [Anthrax bioterrorism 2001, SARS epidemic 2003, U.S. Monkeypox 2003, Hurricane Katrina/Rita 2005, H1N1 influenza pandemic 2009, Haiti Earthquake Cholera Responses 2010-11, Japan Tsunami-Radiation 2011, H7N9 2013, and MERS CoV 2012-3, Coronavirus Response (2013), Unaccompanied Children Central America (2014), Ebola Response (2014-16 and 2018-19) & Zika Virus (2015)].

Dr. Cetron holds faculty appointments in the Division of Infectious Disease at the Emory University School of Medicine and the Department of Epidemiology at Rollins School of Public Health. Dr. Cetron has been a consultant to several WHO Expert Committees: the US delegation intergovernmental negotiations of IHR 2005, the Pandemic Influenza and IHR Review Panel 2010, and the IHR emergency committee roster of independent experts. He was elected in 2016 for a fellowship with IDSA (Infectious Diseases Society of America) & ASTMH (American Society of Tropical Medicine and Hygiene).



### Mark Greenberg

Mark Greenberg joined the Migration Policy Institute as a Senior Fellow in July 2017. His work focuses on the intersections of migration policy with human services and social welfare policies.

From 2009-17, Mr. Greenberg worked at the Administration for Children and Families (ACF) in the U.S. Department of Health and Human Services. He served as ACF Deputy Assistant Secretary for Policy from 2009-13; Acting Commissioner for the Administration for Children, Youth, and Families from 2013-15; and Acting Assistant Secretary from 2013-17. ACF includes the Office of Refugee Resettlement, which has responsibility for the refugee resettlement and unaccompanied children program, and has a strong research agenda relating to the programs under its jurisdiction. Among these are a wide range of human services programs, including Head Start, child care, child support, child welfare, and Temporary Assistance for Needy Families.

Previously, Mr. Greenberg was Executive Director of the Georgetown Center on Poverty, Inequality, and Public Policy, a joint initiative of the Georgetown Law Center and Georgetown Public Policy Institute. In addition, he previously was Executive Director of the Center for American Progress' Task Force on Poverty, and the Director of Policy for the Center for Law and Social Policy (CLASP).

He is a graduate of Harvard College and Harvard Law School and was a legal services lawyer in Florida and California for ten years after graduating law school.



## Zozeya Hassan

Zozeya Hassan is mother of three daughters and survived from ISIS after two years in captivity. She was captured with her two daughters and husband in August 2014 by ISIS in Shingal/Mosul Iraq. After two days she was separated from her husband and father-in-law. She describes her harrowing story as that of other Yazidi women of torture and sexual slavery at the hands of ISIS. She was sold four times as a sex slave in Syria and Iraq and was forced to convert her religion. After two years she was bought back from ISIS by her family, and then brought to Canada by UNHCR. In August 2016 she was resettled to Canada as a government assisted refugee. Currently she is trying to rebuild her life and take care of her children. Her goal is to learn English and go to college. Unfortunately, she has no information about her husband's fate.



## Michael Hollifield

Michael Hollifield received his Medical Degree from the University of Washington School of Medicine, completed dual residency training in Family Medicine and Psychiatry at the University of New Mexico, and advanced training in acupuncture. Dr. Hollifield is the founder, President and CEO of War Survivors Institute and Clinical Professor of Psychiatry and Behavioral Sciences at The George Washington University School of Medicine and Health Sciences, Washington, D.C. He has served as the Section Chief of the Program for Traumatic Stress at the Tibor Rubin VA Medical Center in Long Beach, and is a member of the Alpha Omega Alpha Medical Honor Society.

Dr. Hollifield has helped establish trauma-informed treatment programs for refugees in the U.S. and abroad. His research has focused on improving measurement of trauma and health in refugees and developing novel interventions such as acupuncture, imagery rehearsal therapy, and cognitive behavioral therapy for posttraumatic stress disorder (PTSD). As Evaluation Director for Pathways to Wellness, he led the development and testing of the Refugee Health Screener – 15 (RHS-15). Current research includes further testing of the RHS-15, a grant to continue study about acupuncture for PTSD, and plans to work with warriors and refugees in many countries.



## Arash Javanbakht

Arash Javanbakht, MD, is a psychiatrist and serves as the director of the Stress, Trauma, and Anxiety Research Clinic (STARC). His clinical work is mainly focused on anxiety and trauma related disorders, and PTSD. He often helps civilians and first responders with PTSD. His clinic utilizes pharmacotherapy (medication), psychotherapy, exercise, and lifestyle modification to help patients achieve their full capacity for a fulfilling life.

His research is also focused on anxiety disorders and trauma. Several research studies at the STARC examine the impact of exposure to war trauma in adults and children Syrian and Iraqi refugees, and biological and psychological factors of risk and resilience. This research examines genetic and inflammation correlates of trauma as well. Also, use of art, dance and movement, and yoga and mindfulness in helping refugee families overcome stress.

STARC also works neurobiology of psychotherapy, and on utilization of augmented reality and telemedicine to develop a method of providing in vivo treatment for anxiety disorders and PTSD. Dr. Javanbakht also has a special interest in the “personal meaning” of trauma: how does personal interpretation of a traumatic experience affect the way an individual is affected by it.

Dr. Javanbakht's work has been featured on the CNN, Aljazeera, NPR, Washington Post, Smithsonian, PBS, American Psychiatric Association Press Briefing, Anxiety and Depression Association of America, American Academy of Child and Adolescent Psychiatry, and tens of other media outlets.



## Michael MacKinnon

Hailing originally from Northern Ontario, Michael moved to Ottawa to pursue his studies in the social sciences and completed a Masters of Arts in Soviet and East European Studies, and a Master of Arts in Public Administration. He joined the federal government in 1997, and has worked in a range of departments, most recently in the Public Health Agency of Canada and the Privy Council Office. In September 2014, Michael joined Immigration, Refugees and Citizenship Canada (IRCC) as the Senior Director of Migration Health Policy and Partnerships. In this role he directs the development of policy options, research and relationships in support of IRCC's Migration Health Branch.





## Kimahli Powell

Kimahli has a wide range of experience in the non-profit sector and has spent more than fifteen years advocating for social justice, youth, arts and culture. He was the Director of Development and Outreach at the Canadian HIV/AIDS Legal Network, the Senior Development Officer at Dignitas International, Director of Development at the Inside Out Toronto LGBT Film and Video Festival in addition to holding other director-level positions with non-profit organizations in Toronto and the National Capital Region.

Among Kimahli's achievements in advocacy and social rights, he most recently helped launch the Canadian HIV/AIDS Legal Network's legal challenge to Jamaica's anti-sodomy law, led public outreach initiatives including the Human Rights Networking Zone at multiple international AIDS conferences and guided the Legal Network through a monitoring and evaluation framework on legal advocacy.



## Maya Prabhu

Maya Prabhu, MD, LLB, is an Assistant Professor with the Law and Psychiatry Division at the Yale School of Medicine. Her research and clinical areas of interest include forensic psychiatry, displaced populations, and issues at the nexus of health and international law. Dr. Prabhu obtained her medical degree from Dalhousie Medical School and completed Adult Psychiatry and Forensic Psychiatry training at Yale. Between medical school and residency, she graduated from the McGill Faculty of Law and practiced law with Davis Polk and Wardwell in New York and the United Nations Independent Inquiry into the Iraq Oil-for-Food Program. Dr. Prabhu has worked extensively with attorneys and health care providers on the management of secondary stress syndromes related to trauma-based work.



## Wendy Young

Wendy has led KIND since 2009 and brings extensive immigration policy experience to the organization. Prior to KIND, she served as Chief Counsel on Immigration Policy in the Senate Judiciary Subcommittee on Immigration, Border Security and Refugees for Senator Edward M. Kennedy. She held prior immigration policy positions with organizations such as the United Nations High Commissioner for Refugees, the Women's Refugee Commission, the United States Conference of Catholic Bishops, and the National Council of La Raza. She has also written numerous articles, reports and cutting-edge op-eds on the plight of unaccompanied children.

Wendy has received a number of awards and honors for her work on immigration rights including 2017 Williams College Bicentennial Medal Award; 2016 Keepers of the American Dream Honoree by the National Immigration Forum; Women Inspiring Change 2015 Honoree at Harvard Law School's 2nd Annual International Women's Day Celebration; Foreign Policy's Leading Global Thinker of 2014; Nominated as one of two NGO representatives to participate in Seminar XXI Program on U.S. Foreign Policy by Massachusetts Institute of Technology and National Defense University (2002); Honored by Florida Immigrant Advocacy Center for work on behalf of women and children detainees (2002); Child Advocacy National Certification of Recognition, American Bar Association, in recognition of contributions advancing the welfare of children (2001); Human Rights Award, American Immigration Lawyers Association, in recognition of the work of the Women's Commission for Refugee Women and Children on behalf of women and child asylum seekers (1999).

Wendy earned a joint law degree and master's degree in international relations from American University in Washington, DC, and a bachelor's degree from Williams College in Massachusetts.

## Invited Speaker Bios



### Katherine McKenzie

Katherine McKenzie, MD, FACP is a faculty member at Yale School of Medicine and the Director of the Yale Center for Asylum Medicine (YCAM). She has practiced at medicine at Yale for over 20 years. She teaches undergraduates, students and residents, and is a member of Yale Refugee Health Program. She is a physician advocate for underserved patients, social justice and human rights.

Since 2007, Dr. McKenzie has been the director of the YCAM, where she performs medical forensic evaluations and testifies as an expert witness for asylum seekers referred by law schools, human rights organizations, and immigration attorneys. She works with Physicians for Human Rights and HealthRight International to educate clinicians about asylum medicine. She has written reviews, clinical cases and opinion pieces on asylum medicine in publications including the New England Journal of Medicine, the Journal of General Internal Medicine, the British Medical Journal, the Journal of Forensic and Legal Medicine, Time magazine and CNN, among others.

At Yale, she received the Leonard B. Tow Award for Humanism in Medicine and the Faculty Award for Achievement in Clinical Care. She has been named a “Top Doctor” for many years by Connecticut Magazine. She is a fellow of the American College of Physicians.

Dr. McKenzie earned a bachelor’s degree in Molecular, Cellular and Development Biology at the University of Colorado, Boulder. She received her medical degree from Boston University and completed her residency in internal medicine at University Hospital in Boston. She has been certified with the American Board of Internal Medicine since 1995.



### Gabriel Schirvar

Gabriel Schirvar is the USRAP Program Assistant for the International Organization for Migration (IOM) and has contributed extensively to IOM’s LGBTI-related work. Since joining, they have authored three units of IOM’s comprehensive training package, “Working with LGBTI Persons in Forced Displacement and the Humanitarian Context.” The units prepare staff members to: (1) utilize an intersectional approach when identifying needs, (2) address LGBTI-specific health concerns, and (3) protect LGBTI survivors of sexual and gender-based violence. Gabriel has also created training packages on migrant children and migrants with disabilities. Gabriel has traveled internationally to LGBTI facilitate training for IOM staff in addition to helping develop and lead two workshops for facilitators. Gabriel holds a master’s degree in Global Public Health from the George Washington University in Washington, DC.

## Invited Speakers

### **Paul L. Geltman** MD, MPH

Medical Director for Refugee and Immigrant Health  
Division of Global Populations and Infectious Disease Prevention  
Massachusetts Department of Public Health  
Assistant Professor of Pediatrics, Harvard Medical School  
Associate Professor of Health Policy and Health Services Research  
Boston University Goldman School of Dental Medicine

### **Praseedha Janakiram** MD

Global Health PGY3 Enhanced Skills Co-Coordinator  
Department of Family and Community Medicine  
University of Toronto  
Co-Lead  
Toronto Addis Ababa Academic Collaboration in Family Medicine

### **Patricia Li** MD, MSc, FRCPC

Assistant Professor, Paediatrics  
Division of General Paediatrics, Montreal Children's Hospital  
McGill University Health Centre

### **Sana Loue** JD, PhD, MPH, MSSA

Vice Dean, Faculty Development & Diversity  
Case Western Reserve University School of Medicine

### **Sherri Schwartz** DDS

Manager, Dental & Oral Health Services  
North Region, Toronto Public Health

## Special Refugee Invitees

### **A2VT**

(Said Bulle, George Mnyonge, Benny Nduwayo, Olivier Enwa,  
Timikoru Ingebina)  
Musical Performers and Dancers  
Burlington, VT

### **Zozeya Hassan**

Yazidi Kurdish Woman, ISIS Survivor

## Concurrent Plenary Speakers

### **Marc Altshuler** MD

Associate Professor, Department of Family and Community Medicine  
Associate Program Director, Family Medicine Residency Program  
Director, Jefferson Center for Refugee Health  
Thomas Jefferson University

### **Andrea K. Boggild** MSc, MD, DTMH, FRCPC

Clinical Director, Tropical Disease Unit, Toronto General Hospital  
Parasitology Lead, Public Health Ontario Laboratories  
Assistant Professor, Department of Medicine, University of Toronto

### **Mahli Brindamour** MD, FRCPC

General pediatrician  
Assistant Clinical Professor  
University of Saskatchewan

### **Della Faulkner** PhD, RN

Senior Policy Analyst, Migration Health Policy and Partnerships  
NHQ - Migration Health Branch  
Immigration, Refugees and Citizenship Canada, Ottawa, ON

### **Jordan Jay Feld** MD, MPH

R. Phelan Chair in Translational Liver Disease Research  
Associate Professor of Medicine, University of Toronto  
Research Director, Toronto Centre for Liver Disease  
Senior Scientist, Sandra Rotman Centre for Global Health, TGR1  
Toronto General Hospital

### **Arash Javanbakht** MD

Assistant Professor  
Director of Stress, Trauma, and Anxiety Research Clinic (STARC)  
Department of Psychiatry and Behavioral Neurosciences  
Wayne State University

### **Nazneen Uddin** MD

Family Practice Specialist  
John Muir Health

### **Janine Young** MD, FAAP

Medical Director, Denver Health Refugee Clinic  
Medical Advisor, Colorado Refugee Services Program  
Associate Professor, Dept of General Pediatrics  
University of Colorado School of Medicine  
Denver Health and Hospitals  
Lowry Family Health Center

# Accreditation

## The College of Family Physicians of Canada – MainPro+

This one-credit-per-hour Group Learning program meets the certification criteria of the College of Family Physicians of Canada and has been certified by Continuing Professional Development, Faculty of Medicine, University of Toronto for up to 20.0 Mainpro+ credits.

Day 1: **7.0** MainPro+ credits

Day 2: **7.5** MainPro+ credits

Day 3: **5.5** MainPro+ credits

## Royal College of Physicians and Surgeons of Canada – Section 1

This event is an Accredited Group Learning Activity (Section 1) as defined by the Maintenance of Certification Program of the Royal College of Physicians and Surgeons of Canada, and approved by Continuing Professional Development, Faculty of Medicine, University of Toronto. You may claim up to a maximum of 20.0 hours (credits are automatically calculated).

Day 1: **7.0** Section 1 hours

Day 2: **7.5** Section 1 hours

Day 3: **5.5** Section 1 hours

## American Medical Association – AMA PRA Category 1 Credit™

Through an agreement between the Royal College of Physicians and Surgeons of Canada and the American Medical Association, physicians may convert Royal College MOC credits to AMA PRA Category 1 Credits™. For more information on the process to convert Royal College MOC credit to AMA credits please see: <https://www.ama-assn.org/education/earn-credit-participation-international-activities>.

## European Union for Medical Specialists (EUMS) ECMEC® Credit

Live educational activities recognized by the Royal College of Physicians and Surgeons of Canada as Accredited Group Learning Activities (Section 1) are deemed by the European Union of Medical Specialists (UEMS) eligible for ECMEC®.

## Letters of Accreditation/Attendance

An email with instructions about your accreditation letter will be sent 2 to 3 weeks post-conference.

# Interactive Learning

As part of the Faculty of Medicine's Continuing Professional Development (CPD) Office's mission to help you improve the health of individuals and populations through the discovery, application and communication of knowledge, CPD designs its programming with interactive elements to encourage audience participation. By actively engaging with presenters, fellow attendees and the session materials, you retain an increased amount of content and can discover new ways to apply the knowledge gained. The interactive components for each type of session at this conference are as follows:

**Keynotes:** Each 45-minute keynote session is comprised of a 30-minute presentation followed by a 15-minute Q & A. Participants will be able to submit and up-vote questions on their laptops or mobile devices via Slido.com by entering Osgoode into the event code field (see pg 3 for instructions). Moderators will review the submitted questions and ask the presenters on the audience's behalf during the Q & A.

**Concurrent Plenaries:** Each 60-minute plenary session is comprised of a 45-minute presentation followed by a 15-minute Q & A. Participants will be able to submit and up-vote questions on their laptops or mobile devices via Slido.com by entering the name of the session room (Osgoode, Sheraton, Willow or Chestnut) into the event code field (see pg 3 for instructions). Moderators will review the submitted questions and ask the presenters on the audience's behalf during the Q & A.

**Workshops:** All 60-minute workshop sessions are designed to encourage active discussion throughout the session. A 15-minute period will be reserved at the end for any remaining questions the audience may have.

**Oral Abstract Presentations:** Each 15-minute oral presentation is comprised of a 10-minute presentation followed by a 5-minute Q & A. All oral presentations are grouped by topic into one-hour timeslots. If there is time left at the end of the hour, the audience may ask further questions of all the presenters.

# Faculty Disclosure

It is the policy of the University of Toronto, Faculty of Medicine, Continuing Professional Development to ensure balance, independence, objectivity, and scientific rigor in all its individually accredited or jointly accredited educational programs. All speakers, moderators, facilitators, authors and scientific planning committee members participating in University of Toronto accredited programs, are required to disclose to the program audience any real or apparent conflict(s) of interest that may have a direct bearing on the subject matter of the continuing education program. This pertains but is not limited to relationships within the last FIVE (5) years with for-profit organizations, not-for-profit and public sector sponsors and donors, biomedical device manufacturers, or other corporations whose products or services are related to the subject matter of the presentation. The intent of this policy is not to prevent a speaker with a potential conflict of interest from making a presentation. It is merely intended that any potential conflict of interest should be identified openly so that the listeners may form their own judgements about the presentation with the full disclosure of facts. It remains for the audience to determine whether the speaker's outside interests may reflect a possible bias in either the exposition or the conclusions presented.



# Program Friday, June 14, 2019

0700	Network Breakfast and Registration		Sheraton E
0800	Welcome and Opening Remarks	Anna Banerji	Osgoode
0815	<b>Keynote:</b> What the Rohingya Crisis Teaches Us About Refugees	The Honourable Bob Rae	Osgoode
0900	<b>Keynote:</b> Trends in Migration Health: Are There Lessons from Regularized Migration That Can Be Applied Irregular Migration Flows?	Martin Cetron	Osgoode
0930	<b>Keynote:</b> Immigration, Refugees and Citizenship (IRCC): Latest Developments on Refugee Health	Michael MacKinnon	Osgoode
1000	Refreshments		Sheraton E
1015	<b>Oral Presentations</b>		
Advocacy	0 Forced Migration from Central America: Médecins Sans Frontières Responding to a Humanitarian Crisis	Linn Biorklund Belliveau	Sheraton B
	0 Expanding the Circle of Care: Embedded Interpreters as an Effective Resource for Overcoming Cultural and Linguistic Barriers	Will Allen	
	0 Lessons Learned from the Formation of the Refugee and Immigrant Health and Wellness Alliance of Atlanta (RIHWA)	Parminder Suchdev	
Chronic Diseases	0 Diabetes and Disasters: Challenges and Obstacles	Nizar Albache	Sheraton A
	0 Outcomes of the Diabetes Care Program for Syrian Refugees in Lebanon	Ibrahim al-Masri	
	0 Upstream Prevention: Grappling with Hypertension in a Kenyan Refugee Camp	Naima Osman	
Education	0 Implementation of a Health Systems Navigation Curriculum for Refugees	Pooja Agrawal	Willow West & Centre
	0 Creating MABHI: A Health Information Resource for the Refugee and Immigrant Community in Kansas City	Julie Robinson	
	0 Community Health Training on the Thai-Burma Border	Kaitie Warren	
	0 Building Relationships through Health Education and Promotion: Findings from the Nashville Neighbors Pilot	Marianne Zape	
Global Migration/ Migration	0 “My Heart Feels Chained”: The Relationship Between Economic Precarity and Health for Syrian Refugee Parents Living in Lebanon	Bree Akesson	Willow East
	0 Updates on IOM Pilot Intervention to Improve Continuity of Care of U.S.-bound Refugees with Complex Medical Conditions	Susan Dicker	
	0 Increasing Health Access for Immigrants and Refugees via a Nurse Advice Line in Denver, Colorado	Cara Harasaki	

Mental Health	0	Collaborative Mental Health Care with Refugees using Narrative Exposure Therapy	Azaad Kassam	Sheraton C
	0	Severity of Psychological Distress and Suicidal Ideation among Asylum Seekers	Anna Leiler	
	0	Depression among Middle-Aged and Older Canadian Refugees in the Canadian Longitudinal Study on Aging: The Fundamental Role of Social Support	Shen (Lamson) Lin	
	0	Coming to the U.S. is a “Different Hard Time.” Promoting Mental Health Awareness with Resettled Refugees	Margaret Costantino	
Paediatric Health	0	Academic Achievement and Psychosocial Adjustment in Refugee School-Aged Children - A Systematic Review	Fariba Aghajafari	Maple
	0	Barriers to Student Immunization at a Refugee-Centred School in Ontario - Filling a System Gap	Tomoko Fukushima	
	0	Blood Lead Levels among Afghan Special Immigrant Children in 9 US States, 2014-2016	Clelia Pezzi	
Refugee Screening	0	Health Profile of Pediatric Special Immigrant Visa Applicants from Iraq and Afghanistan, 2009-2017	Simone Wien	York
	0	Health Profile of Adult Special Immigrant Visa Applicants from Iraq & Afghanistan, Electronic Disease Notification System, 2009-2017	Gayathri Kumar	
	0	Role of Pre-departure Health Assessment in Detecting Undiagnosed Medical Conditions Among Refugees: Jordan Experience 2018	Rasha Shoumar	
Research	0	Knowledge Translation and Better Healthcare for Migrants in Canada: What is the Responsibility of Health Funders and Researchers?	Lisa Merry	Chestnut
	0	Ethics and Refugee Health: A Review of Ethical Considerations and Procedures in Published Refugee Health Literature, 2015-2018	Nina Marano	
	0	Conducting Research in Post-Conflict Settings: Lessons from Northern Sri Lanka	Fiona C. Thomas	
	0	Examining Stakeholders’ Views on Refugee Healthcare Needs, Future Healthcare Direction, and Current Barriers in Accessing Healthcare Services in New Zealand	Bafreen Sherif	
Syrian Refugee Crisis	0	Clinic Utilization at a Specialized Refugee Health Clinic in Calgary, Canada: before, during and after the Syrian Refugee Initiative	Eric Norrie	Spruce
	0	Healthcare Providers’ Experiences During a Syrian Refugee Influx Among a Dedicated Refugee Clinic and Partner Community Clinics in Calgary, Canada	Gabriel Fabreau	
	0	Depression among Syrian Refugees: Findings from a Canadian Longitudinal Study	Farah Ahmad	
1015	W	Strategies for Publishing and Publicizing Your Work in Refugee Health	Sana Loue, Paul Geltman	Osgoode

1115	Travel Time		
1130	<b>Concurrent Plenary #1</b> Getting on Track for Elimination of Viral Hepatitis, What will it Take?	Jordan Feld	Chestnut
	<b>Concurrent Plenary #2</b> Refugee Health Doctors: Share your Thoughts on the Canadian Immigration Medical Screening of Refugees	Della Faulkner	Sheraton C
	<b>Concurrent Plenary #3</b> Understanding, Detecting, and Addressing Trauma and PTSD in Refugees	Arash Javanbakht	Willow West & Centre
	<b>Concurrent Plenary #4</b> North American Pediatric Refugee Screening Guidelines - Evidence and Key Recommendations	Janine Young, Mahli Brindamour	Osgoode
1230	Buffet Lunch   Posters and Exhibitors		Sheraton E
1330	<b>Workshops   Session 1</b>		
	<b>W Asylum</b> 2019 Update in US Asylum Law and Asylum Medicine	Katherine McKenzie, Sural Shah	Willow West & Centre
	<b>W Chronic Diseases</b> Developing and Implementing a Diabetes Care Program for Urban and Peri-Urban Syrian Refugees in Lebanon	Ibrahim Al Masri	Sheraton A
	<b>W Communication 1</b> Deaf Refugee Advocacy -The Benefits of Using Deaf Advocates for Deaf Refugee	Diana Pryntz	Willow East
	<b>W Communication 2</b> Culturally Adapting and Translating Screening Tools: Best Practices and Lessons Learned	Abigail Grant	Maple
	<b>W Dentistry</b> Identification and Management of Common Dental Issues Among Refugees for the Non-Dental Professional	Sherri Schwartz	Chestnut
	<b>W Infectious Disease</b> How Do We Make the Link? HIV Primary Care for Newcomer Refugees and Linking to Care in Toronto, Ontario	Praseedha Janakiram	Sheraton C
	<b>W LGBTI+</b> Providing Culturally Appropriate Care for LGBTI+ Migrants and Refugees (Part 1)	Gabriel Schirvar	Osgoode
	<b>W Systems</b> First Point of Contact: Canada's Refugee Health Clinics: Structure, Care Models, Strengths and Challenges	Meb Rashid	Sheraton B
1430	Travel Time		
1445	<b>Workshops   Session 2</b>		
	<b>W Asylum</b> "My Lawyer Said I Need a Doctor's Letter...": Enhancing Medical Reports for Refugee Claims in the Canadian Context	Vanessa Redditt	Sheraton B
	<b>W Chronic Diseases</b> The Cards you are Dealt: Exploring Post-Migration Case-Management for Newcomers with Complex Health Needs	Sara Abdo	Sheraton A
	<b>W Communication</b> How to Talk to your Informatics Team about Electronic Health Record-Based Tools to Promote Refugee Health Screening	Evan Orenstein	Spruce

	<b>W</b>	<b>Mental Health</b> Strategies for Engaging Refugee Communities in Mental Health Services	Emma Cardeli	Maple
	<b>W</b>	<b>LGBTI+</b> Providing Culturally Appropriate Care for LGBTI+ Migrants and Refugees (Part 2)	Gabriel Schirvar	Willow West & Centre
	<b>W</b>	<b>Paediatric Health</b> Controversies and Challenges in Pediatric Refugee Care	Mahli Brindamour	Chestnut
	<b>W</b>	<b>Refugee Education</b> Immigrant and Refugee Health Curricular Development Working Group	Sural Shah	Sheraton C
	<b>W</b>	<b>Women's Health</b> Ethics of Practice with Resettled Refugee Women: Cultural Competence Workshop	Erum Agha	Willow East
1545		Refreshments		Sheraton E
1600		<b>Keynote:</b> Protecting Some of the Most Vulnerable People: Unaccompanied Refugee Children from Central America ..... Wendy Young		Osgoode
1645		Refugee Stories and Entertainment From A2VT ..... A2VT		Osgoode
1735		Reception   Posters and Exhibitors		Sheraton E
1830		Adjourn Day 1		

## Program Saturday, June 15, 2019

0700		Breakfast and Registration		Sheraton E
0700		Asylum Medicine Interest Group Breakfast (Open to All)		Sheraton A
0800		<b>Keynote:</b> Silencing and Awakening from Trauma	Michael Hollifield	Osgoode
0845		<b>Keynote:</b> North America's Role in Protecting LGBTQI Refugees. A Canadian Perspective	Kimalhi Powell	Osgoode
0900		Journal of Immigrant and Minority Health: Manuscript Consultations (0900-1100 Pre-Signup Required)	Paul Geltman	Spruce
0930		Refreshments		Sheraton E
0945		<b>Oral Presentations   Session 2</b>		
	<b>O</b>	The Proposed Rule on Public Charge and Its Implications for U.S. Citizen Children with Noncitizen Parents	Katalin Vinkler	Osgoode
	<b>O</b>	Healthcare for Refugees: Reflections on Advocacy Efforts in Alberta	Astrid Velasquez	
	<b>O</b>	Canadian Born Children Whose Parents Have Precarious Immigration Status: A Strategy to Guarantee Access to Health Care in Quebec	Chloé Cebon	
	<b>O</b>	Access to Tuberculosis Diagnosis and Treatments for Uninsured Migrants in Quebec: The Struggle and the Initiatives	Justine Daoust-Lalande	



Education	0	Beyond the Clinic: The Evolution of Refugee Health Education Towards Holistic Care, Community Engagement and Interaction within MUN MED Gateway	Nguyet Nguyen	Willow West & Centre
	0	Serving Bhutanese-Nepali Patients in an Urban Family Medicine Residency Clinic	Jamie Robinson	
	0	Utilization of Refugee/Immigrant Health Guidelines and Resources by Trainees at a Large US Children's Hospital	Dibya Subedi	
	0	Incorporating Health and Human Rights in Medical Education	Hope Ferdowsian	
Global Health/Migration/Settlement	0	Expect the Unexpected: From Registration till Resettlement of Urban Rohingya Refugees – the Experiences of UNHCR and IOM Malaysia	Chun Ting Wong	Sheraton C
	0	A Physical Exam Quality Control Tool for the Refugee Health Assessment	Alexander Rowan	
	0	A Physical Exam Guide to Improve Diagnosis in Refugees	Alexander Rowan	
	0	Managing Mental Health of Refugees in a Remote Setting – Experience from Kigoma	Nicholaus Nderero	
Paediatric Health	0	Infant Feeding Patterns Among Refugees in Athens, Greece: 2017-18	Anne Merewood	Chestnut
	0	Identifying Sources of Strength and Stress in Young Refugee Families Before and After Migration to the United States	Elizabeth Dawson-Hahn	
	0	Promoting Refugee Infant Development through Examining Risk and Resilience Models	Anne Brassell	
Refugee Screening	0	Outcomes of a Breast Cancer Awareness and Screening Program among Syrian Women Refugees in Lebanon	Ibrahim AlMasri	Sheraton B
	0	The e-STAR-MH: A Rapid, Digital Screening Tool for Mental Disorders in Asylum Seekers and Refugees	Debbie Hocking	
	0	Barriers to TB Evaluation and Treatment among Immigrants and Refugees-Arizona, 2015-2017	Amanda Swanson	
	0	Access to Mental Health Care for Resettled Refugees in the United States: Perspectives of Frontline Refugee Resettlement Professionals	Justine Lewis	
Research	0	A Home Visit Model for Health Education for Newly Resettled Refugee Families	Romany Redman	Sheraton A
	0	Factors in Young Adult Refugees' Primary Care Use	Sarah Brewer	
	0	Towards an Understanding of Women's Service and Support Needs Related to Intimate Partner Violence in Resettlement	Karin Wachter	
	0	The Role of General Practice in Meeting the Needs of Refugees and Asylum Seekers: Learning from Sweden, Germany, and Italy	Jessica Smith	

Syrian Refugee Crisis	O	Mapping Diverse Genetic Disorders and Rare Diseases among Syrian Population: Implications on Refugee Health and Health Services in Host Countries	Soha Yazbek	Willow East
	O	Spirituality as a Pillar of Hope for Syrian Refugee Families: Creating Culturally Appropriate Mental Health Services in Lebanon	Bree Akesson	
	O	Early Primary Care Navigation of Population-based Cohorts of Resettled Refugees in Ontario: Findings from the Syrian Commitment	Astrid Guttman	
	O	The Impact of Unemployment on the Mental Health Status of Syrian Refugee Men Resettling in Canada	Jonathan Bridekirk	
Women's Health	O	Voices of Women Refugee Claimants Accessing Reproductive Health Care Services in Toronto, Ontario, Canada	Hellen Gateri	Maple
	O	Prenatal Group Visits for Afghan Refugee Women	Shoshana Aleinikoff	
	O	The Women Wellness Program- A Culturally Customizable Program for Newcomer Women	Khaled Elkazaz	
	O	Perinatal Health Care Through a Refugee Lens	Kendra Weerheim	
1045	Travel Time			
1100	<b>Concurrent Plenary #1</b> Best Practices for Conducting Asylum Evaluations		Katherine McKenzie	Osgoode
	<b>Concurrent Plenary #2</b> Updates to CDC's Domestic Screening Guidelines for Adult Refugees		Marc Altshuler	Willow West & Centre
	<b>Concurrent Plenary #3</b> The Rohingya: A People of Resilience		Nazneen Uddin	Sheraton C
	<b>Concurrent Plenary #4</b> Parasites and Workup of Eosinophilia in Refugee Populations		Andrea Boggild	Chestnut
1200	Buffet Lunch			Sheraton E
	<b>Film:</b> Health Undocumented (Film about the building of a unique free clinic serving undocumented immigrants. Director & Producer in attendance)		Juan Freitez, Chelsea Soyring	Sheraton A
	<b>AGM:</b> Society of Refugee Healthcare Providers AGM & Student Poster Competition Award		James Sutton	Osgoode
1330	<b>Workshops   Session 3</b>			
	<b>W</b>	<b>Asylum</b> How to Be an Effective Clinician Advocate: Speaking, Writing and Organizing in Support of Refugees and Asylum Seekers	Katherine McKenzie	Osgoode
	<b>W</b>	<b>Chronic Diseases</b> Improved Medication Adherence and Outcomes in Refugees with LTBI and Chronic Disease through Incorporation of Clinical Pharmacists into Interdisciplinary	Kimberly Carter	Chestnut
	<b>W</b>	<b>Communication</b> Framing Works! How to Use Evidence-Based Communication Tools to Advocate for Immigrant and Refugee Families	Julie Linton	Willow East

	<b>W</b>	<b>Global</b> “Are They Genuine Refugees?” ...I Didn't Really Need to Know. Dual Loyalty and Political Discourse within Australia's Immigration Detention System	Ebony Birchall	Sheraton C
	<b>W</b>	<b>Mental Health</b> Best Practices in Mental Health Assistance to Refugees and Immigrants	Adrienne Carter	Willow West & Centre
	<b>W</b>	<b>Refugee Education</b> Healing Trauma Through The Creation of Safe Spaces	Omar Reda	Sheraton A
	<b>W</b>	<b>Refugee Screening</b> Delivering Refugee Healthcare in a Community Setting	Satoko Kanahara	Maple
	<b>W</b>	<b>Research</b> Improving Health by Engaging Refugees: Creating a Community-based Research Network	Sarah Brewer	Sheraton B
1430	Travel Time			
1445	<b>Workshops   Session 4</b>			
	<b>W</b>	<b>Advocacy</b> Leveraging the Medical-Legal Partnership for Detained Immigrants: Ending Deaths in Detention	Kate Sugarman	Sheraton C
	<b>W</b>	<b>Asylum</b> Challenges in Founding and Developing Student-Run Asylum Clinics	Fangning Gu	Maple
	<b>W</b>	<b>Communication</b> Setting the Triadic Stage for Success: Working effectively with healthcare interpreters to overcome language barriers	Rosanna Balistreri	Spruce
	<b>W</b>	<b>Global</b> A Project to Enhance Mental Health Screening in the Humanitarian Setting	Michael Hollifield	Osgoode
	<b>W</b>	<b>Immunization</b> Immunization Considerations in Refugee Children	Patricia Li, Paul Geltman, Mahli Brindamour	Willow West & Centre
	<b>W</b>	<b>Mental Health 1</b> Behavioral Health Integration and Team-Based Care in an Immigrant-Refugee Health Clinic	Laurie Greco	Sheraton B
	<b>W</b>	<b>Mental Health 2</b> Promising Practices of Trauma Treatment for Refugees, Social Work Perspective	Asmaa Cober	Willow East
	<b>W</b>	<b>Paediatric Health 1</b> Trauma-Informed Approach for Working with Child and Youth Survivors of War and Torture	Nadia Umadat	Chestnut
	<b>W</b>	<b>Paediatric Health 2</b> A Migrating Adolescence: Caring for Unaccompanied Minors Seeking Asylum in the United States	Karla Fredricks	Sheraton A
1545	Refreshments			Sheraton E
1600	<b>Keynote:</b>	Refugee Stories: Escape from ISIS	Zozeya Hassan	Osgoode
1700	Adjourn Day 2			

# Program Sunday, June 16, 2019

0730	Breakfast and Registration		Sheraton E
0800	Breakfast with the Experts: (Pre-Signup Required)		Sheraton C
0900	<b>Keynote:</b> Stress, Risk and Resilience in Syrian Refugees in the US: A Project of Prevalence, Culture, Environment, Interventions, and Illness Course	Arash Javanbakht	Osgoode
0945	<b>Keynote:</b> Responding to the Needs of Border-Crossing Children	Mark Greenberg, Paul Caulford	Osgoode
1030	Refreshments		Sheraton E
1045	<b>Oral Presentations   Session 3</b>		
	<b>O</b> Social Capital: Supportive of Bhutanese Refugees' Integration in the U.S.	Justine Lewis	Willow West & Centre
	<b>O</b> The Cultural Aspects of Foraging Behavior of S.E. Asians and the Associated Risks	Theresa Mata	
	<b>O</b> The U.S. Refugee Health Promotion Program: A National Overview	Allison Pauly	
<b>LGBTI+</b>	<b>O</b> Beyond Positive Intentions: Providing Equitable Services for Newcomer LGBTQ+ Refugee Women	Serena Nudel	Sheraton C
	<b>O</b> Mental Health and the Post-Migration Experiences of LGBTQ Asylum Seekers in North America	Samara Fox	
	<b>O</b> "Casualties of Care": LGBTQ+ Asylum Seekers in Canada	Khadijah Kanji	
<b>Mental Health</b>	<b>O</b> Bringing Mental Health to Refugees in the Afterschool Space: From Chaos to Calm	Lenita Dunlap	Osgoode
	<b>O</b> Compassionate Listening: Effective Care for Refugee Clients in Primary Care Settings	Joanne Gardiner	
	<b>O</b> Cultural Consultation: A Model for Working with Refugee Trauma	Ayse Ceren Kaypak	
	<b>O</b> Two Steps Forward, One Step Back: Using Maslow's Hierarchy of Needs to Understand Refugee Integration Status	Lisa Gren	
<b>Research</b>	<b>O</b> Pilot Assessment of Infant Feeding in Emergencies Implementation at Refugee Camps in Attica, Greece	Anne Merewood	Chestnut
	<b>O</b> Including participants: Examining the implementation of Community-Based Participatory Research (CBPR) to empower the Somali community in Arizona	Cynthia Mackey	
	<b>O</b> A Scoping Review on Approaches and Interventions that Target Gender-Based Violence amongst Refugee Youth	Tali Filler	



Rohingya Refugee Crisis	O	Community-Led Emergency Medical Services to Improve Health Outcomes for Rohingya Refugees in Cox's Bazar, Bangladesh	Punam Ganguly	Sheraton B
	O	Capacity-Building in Evidence-based Psychotherapy for Distressed Rohingyas in Camps at Cox's Bazar, Bangladesh	Lena Verdeli	
	O	Providing Medical Care and Psychosocial Support to Rohingya Refugee Survivors of Sexual Violence	Colleen Dockerty	
Women's Health	O	Community Conversations: The Importance of Community Engagement in Improving the Care and Reducing the Risk of Female Genital Cutting	Hilary Chester	Sheraton A
	O	Gender and Intersectionality among Refugee Women's Health in Canada: Knowledge Translation and Exchange Exercise	Sheikh Muhammad Zeeshan Qadar	
	O	Current Progress and Future Directions in the Double Burden of Malnutrition among Women in South and Southeast Asian Countries	Tuhin Biswas	
1145	Buffet Lunch   Posters and Exhibitors			Sheraton E
1245	<b>Workshops   Session 5</b>			
	W	<b>Paediatric Health 1</b> Supporting Immigrant and Refugee Parents When Their Children Are Ill or Have a Special Health Need	Judith Colbert	Willow East
	W	<b>Paediatric Health 2</b> Pediatric Guidelines for Refugee Health Screening: Understanding the Evidence from Canada and the US	Janine Young	Willow West & Centre
	W	<b>Refugee Screening</b> Update on the Centers of Excellence in Refugee Health Tools for the Refugee Health Community	Emily Jentes	Osgoode
	W	<b>Research</b> Refugee Health Literature and Research 101: A How to Guide	Natalia Golub	Sheraton C
	W	<b>Self-Care</b> Care for the Carers: Managing Secondary Trauma Exposure for Clinicians	Rachel Cohen	Chestnut
	W	<b>Vaccination</b> Bridging Gaps in Vaccination for US-bound Refugees	Kibrten Hailu	Sheraton B
	W	<b>Women's Health</b> Refugee Health and the Intersection of Forced Marriage and Female Genital Mutilation/Cutting	Casey Swegman	Sheraton A
1345	Travel Time			
1400	<b>Workshops   Session 6</b>			
	W	<b>Access to Care</b> OHIP for All: Fighting for Access to Healthcare for All Residents of Ontario	Thrmiga Sathiyamoorthy	Sheraton A
	W	<b>Global</b> Road to Refuge: Overview of the Refugee Claimant/Asylum Seeker Process and Its Impact on Health in Canada and the USA	Meb Rashid	Sheraton B
	W	<b>Mental Health I</b> Mindfulness, Values, and Exposure: An Integrative Approach to Treating PTSD and Depression in Arabic-speaking Refugees	Laurie Greco	Chestnut

	<b>W</b>	<b>Mental Health 2</b> Dance/Movement Therapy Techniques for Addressing Trauma in Refugees	Lana Grasser	Sheraton C
	<b>W</b>	<b>Systems</b> Roundtable for Clinic Directors on Sharing Successful Funding Strategies	Michael Stephenson	Willow West & Centre
	<b>W</b>	<b>Women's Health</b> Caring for Pregnant Women outside of the Public Medical System: Ethical Dilemmas and Making Medical Decisions	Justine Daoust-Lalande	Osgoode
1500		Refreshments		Sheraton E
1515		<b>Keynote:</b> Staying Resilient in a Crisis Driven Environment	Maya Prabhu	Osgoode
1600		Closing Remarks	Anna Banerji, James Sutton	Osgoode
1615		Adjourn		

# Posters Friday, June 14, 2019 (8am-6pm)

Sheraton Hall E

Poster #	Title
1	A Systematic Review into Refugee Perceptions of Using the Australian Healthcare System . . . . . Michael Au
2	Best Practices for Evaluating LGBTQ Asylum Seekers: A Curriculum for Clinicians in the MGH Asylum Clinic . . . . . Nathan Praschan
3	Enhancing Resettlement through an Innovative Interprofessional Team Approach. . . . .Stephen Kern
4	Bonding, Bridging, and Linking: Social Capital and Its Potential Health Impact Among Refugees in Their Resettlement Countries . . . . . Huaibo Xin
5	Social, Graphical, and Geospatial Mapping of Social Capital among Bosnian Refugees in the U.S.: Implications on Bosnians' Mental Health . . . . . Huaibo Xin
6	Identifying Maternal Healthcare Needs of Pregnant Refugee Women in Utah . . . . . Sheri Palmer
7	Cuban Health Outcomes in Texas: Those Paroled into the U.S. at Border vs. Those Who Obtained Refugee/Parolee Status in Cuba . . . . . Emily Jentes
8	Healthcare Access for Syrian Refugees and the Jordanian Host Community in Northern Jordan: A Qualitative Study . . . . . Dalia Alnuaimi
9	Primary Care Experiences of Young Adult Refugees after Resettlement . . . . . Sarah Brewer
10	Family Planning Utilization in U.S.-Based African Refugee Women . . . . . Kafuli Agbemenu
11	Uconn Immigration Rights Initiative: The Development of a Student Run Asylum Clinic and an Avenue for Refugee Advocacy. . . . . Susan Levine
12	Supporting Mental Health of Syrian Refugee Mothers: A Collaboration among Community Stakeholders, Syrian Community Members and Researchers . . . . . Joyce O'Mahony
13	Vaccination among Refugees from Ukraine. . . . . Nonna Netiazhenko
14	Type of Torture as a Predictor of PTSD Symptomology . . . . . Phyu Pannu Khin
15	Vaccine Preventable Outbreaks in Burundi, Rwanda, Tanzania, Uganda and Its Impact on Refugee Resettlement . . . . . Warren Dalal
16	Connecting Overseas Refugee Vaccinations to State Immunization Information Systems . . . . . Amanda Dam
17	Electronic Disease Notification System: Providing Immigrant and Refugee Arrival Notification and Health Information to US Health Partners . . . . . Amanda Dam
18	Association of Eosinophilia with Nematode Parasitic Infection in Refugees in Thailand: Common but of Limited Clinical Utility . . . . . Jessica Webster
19	Immunization Coverage among Colorado Refugee Arrivals . . . . . Lori Kennedy
20	Understanding the Birth Experience of Afghani Muslim Women at a US Teaching Hospital . . . . . Karen Maughan
21	Creating a Coordinated Inter-Professional and Inter-Sectoral Mental Health System for Refugee Youth in Calgary, Alberta: A Streamlined Approach. . . . . Jacqueline Bobyn

Poster #	Title
22	Comparison of Select Health Outcomes in Humanitarian Immigrants in Maryland, 2013-2018. . . . .Matthew Dory
23	Reproductive Health Needs of Resettled Refugee Women: A Call for Action. . . . . Erum Agha
24	Experience of Pre and Postpartum Care for Syrian Women in Kingston: A Preliminary Study . . . . . Supaporn Trongsakul
25	Integrating Behavioral Health within a Primary Care Refugee Clinic . . . . .Danielle Fitzsimmons-Pattison
26	Health and the Housing Interface: Experience of Precarious Housing Amongst Refugees in Melbourne, and the Perceived Impacts of Precarious Housing . . . . .Joanne Gardiner
27	Family-Based Pediatric Health Education Pilot Program for Refugees . . . . . Henna Shaikh
28	A Diabetes-Focused Curriculum Helps Improve Overall Understanding and Management of Illness . . . . . Umar Qadri
29	Challenges of Health Assessment for LGBTQI Refugees. . . . . Anita Davies
30	The Mental Health of Syrian Refugee Adolescent Girls in the Amenah Early Marriage Intervention. . . . . Lama Al Ayoubi
31	Outbreaks of Vaccine Preventable Diseases in Refugee Camps – A Systematic Review . . . . . Julia A Steinle
32	Transnational Family Support: Perspectives from Family Members Back Home; A Feasibility and Pilot Study in Kisumu, Kenya. . . . . Lisa Merry
33	Impact of the International Organization of Migration (Kenya) Teleradiology System in Refugee Health Screening in Africa. . . . . Betty Bonass
34	Oral Health of Newly Arrived Humanitarian Immigrants in Quebec and Ontario; A sequential mixed methods protocol. . . . . Nazik M Nurelhuda
35	Lead Exposure in Newly Resettled Pediatric Refugees in Syracuse, NY . . . . . Christina Lupone
36	Inter-Professional, Community-Based, Experiential Learning with Refugee Families Supports Community Health Advocacy . . . . . Andrea Shaw
37	Personal Hygiene and Its Implications to Health Service Among Refugees in the USA . . . . .Abdulgafar Ibrahim
38	Refugee and Immigrant Health and Wellness Alliance of Atlanta (RIHWA) Community Assessment . . . . .Manal Sidi
39	Promoting Infant and Early Childhood Vaccines in a Refugee Population . . . . . Sarah Spriggs
40	A Systematic Review of HIV Risk-Reduction Interventions among Refugees and Asylum Seekers. . . . . Rania Ali
41	Experience Implementing Shareable Clinical Decision Support for Refugee Health Screening at 2 Institutions: Lessons Learned . . . . .Evan Orenstein
42	Parental Knowledge and Perceptions about the Risk of Childhood Lead Poisoning among Bhutanese Community in Northeast Ohio. . . . . Sunita Shakya
43	Empowering Refugee Women: Increasing Access to Sexual and Reproductive Health Education and Services through Community Partnerships . . . . . Grace Paulsen
44	Group Visits for Socially Isolated Bhutanese Refugee Elders . . . . . Reagan Thompson
45	Evaluation of 5-Item Mental Health Screener from the Perspective of Providers and Refugees. . . . . Connor Malley

# Posters Sunday, June 16, 2019 (9am-4pm)

Sheraton Hall E

Poster #	Title
46	Social and Cultural Considerations in Involving Ethnic Minorities as Patient/Partners in Health Research . . . . . Bushra Mahmood
47	Nursing Students Act to Promote Acculturation for Refugee Families . . . . . Debra Mills
48	Determining Health Conditions Present in Refugees Age 0-59 Years Arriving in Utah . . . . . Lisa Gren
49	Providing Refugee Integration Services – How Well Are US States Doing? . . . . . Lisa Gren
50	Overview of U.S.-Bound Refugee Arrivals, Overseas TB Screening, and Domestic Follow-Up Evaluation for Fiscal Year 2018 . . . . . Zanju Wang
51	Examining the Correlation between Participation in Leisure Activities and Pain and Depression in Syrian Refugees Relocated in Jordan. . . . . Elizabeth Palmer
52	The Lived Experience of Syrian Refugees/Newcomers in New Brunswick Canada: A Descriptive Phenomenological Study . . . . . Khaldoun Aldiabat
53	Creating a Hepatitis B Indicator to Compare Disparate Data Sources. . . . . Breanna Kawasaki
54	Barriers and Facilitators of Immunization in Refugees and Migrants in Australia: An East-African Case Study . . . . . Ikran Abdi
55	Improving Health by Engaging Refugees in Denver (I-HEaRD) Project: Creation of a Community-Based Research Network (CBRN) . . . . . Anne Lambert-Kerzner
56	Impact of Nature-Based Leisure Programming on Refugee Mental Health . . . . . Janna Mulholland
57	Early Changes in Body Mass Index among New Adult Refugees to the U.S. . . . . Ellen Einterz
58	Measles Mumps and Rubella (MMR) Vaccination Hesitancy in a Somali Population in Rural Nebraska . . . . . Melanie Menning
59	La Maison Bleue: Strengthening Resiliency among Recently-Arrived Migrant Mothers Living in Montréal, Canada. . . . . Lisa Merry
60	Addressing Syrian Refugee Adolescents' Mental Health and Wellbeing: Youth-Informed Policy Implications . . . . . Tali Filler
61	Identifying Barriers to Emergency Care for Immigrants, Refugees, and Patients with Limited English Proficiency. . . . . Nivedita Poola
62	An Analysis of the Ethnobotanical Knowledge of Indigenous Tribes of Vietnam (The Montagnards) Now Living in Greensboro, NC, USA. . . . . Catherine Bush
63	Reducing Barriers and Facilitating Resilience: A Case Study of Two Refugee Women with Peripartum Depression in British Columbia, Canada. . . . . Jeanette Somlak Pedersen
64	Social Connections and Attitudes about Reproductive Health among Resettled Refugee Women: A Systematic Review . . . . . Sarah Richards-Desai
65	Utilization of Quality Improvement Methodology to Improve Mental Health Care Access in an Immigrant and Refugee Health Clinic . . . . . Lily Sonis

Poster #	Title
66	Developing an Acuity Scale for Case Management and Primary Healthcare for Refugees Age 60 Years and Older Arriving in Utah . . . . .Lisa Gren
67	Displaced Persons and Vaccine-Preventable Diseases: An Analysis of ProMED Reporting Data. . . . . Angel Desai
68	Exceptional Refugees: A Medical-Legal Partnership Model for N-648 Evaluations . . . . .Mustafa Abid
69	Scaling up Interpersonal Psychotherapy for Persons Affected by the Syrian Crisis in Lebanon . . . . . Lena Verdeli
70	Assessing Acculturation, Mental Health and Trauma Symptoms among Ethiopian Emigrants in the US. . . . .Waganesh Zeleke
74	Case Study: A Refugee's Journey through the Resettlement Process and the Hurdles Encountered . . . . .Catherine Boinett
75	Connect Soccer Academy: A Model for Building Resiliency in Refugee Youth through Trauma-Informed Coaching. . . . . Bryan Rego
76	Tell Your Story so We Can Help - There Is No Shame in Mental Health . . . . . Anita Davies
77	Lessons Learned from a Pharmacist-Managed Latent Tuberculosis Management Program . . . . .Ann Philbrick
78	Translating Needs to Clinical Service: An Innovative Care Model for Refugee Newcomers in Waterloo Region . . . . . Will Allen
79	A Narrative-Based Approach to Understanding Health Needs and Experiences among Syrian Refugees in Amman, Jordan . . . . . Lanbo Yang
80	A Syrian Refugee with Batten Disease Finds Hope of a Cure after Resettlement in the United States. . . . .Dawn Lammert
81	A Mobile Health Intervention Utilizing Community Partnerships to Improve Access for Latent Tuberculosis Infection Treatment. . . . . Padma Swamy
82	Pre-Departure 21 Days Ebola Virus Disease Surveillance among Resettling Refugees Due to EVD Outbreak in Democratic Republic of Congo (DRC) . . . . . Mukunda Basnet
83	Montreal and Toronto as Sanctuary Cities: A Comparison of Public Health Policy Towards Refugees, Asylum Seekers and Undocumented Migrants. . . . . Ahmed Faress
84	Building Bridges: Improvement of Refugee Health Care through Community Voices . . . . .Rinki Goswami
85	Syrian Refugee Patients' Perceptions of Care among a Specialized Refugee Clinic and Partner Community Clinics in Calgary, Canada . . . . . Ibrahim AlMasri
86	A Complicated Case of Pediatric Obesity, an Increasing Public Health Challenge for Refugee Families. . . . .Kimberly Wells
87	Operational Response Leaders' Perspectives of a Rapid Syrian Refugee Influx to Calgary, Canada . . . . . Gabriel Fabreau
88	The Health Liaison Nurse: What Role Do They Play in Refugee Migration?. . . . .Mia Baluyut
89	Policy Implications for Mental Health Service Utilization among Refugees in America . . . . . Michelle Reece
91	A Literature Review Examining Issues Prevalent among Rohingya Refugee Women: Implications for Medicine, Public Health, and Human Rights . . . . .Afnan Naeem
92	Sanctuary Refugee Health Centre (Sanctuary): A Unique Model of Practice . . . . .Afnan Naeem





# Sponsors

## Gold



## Silver



## Bronze



## Not-for-Profit Partner



Thank You for the Generous Grant and Contribution from:

